

1. ALL DIMENSIONS ARE IN METRES UNLESS NOTED OTHERWISE
2. ALL JUNCTION LAYOUTS AREA INDICATIVE
3. THIS DRAWING IS BASED ON ORDNANCE SURVEY MASTERMAP MAPPING, AND AS SUCH, ALL INFORMATION SHOWN IS APPROXIMATE ONLY.
4. ALL ROAD WIDTHS SHOWN, AS WELL AS POSITIONS OF EXISTING STREET FURNITURE, ARE APPROXIMATE ONLY.
5. VEHICLE TRACKING SHOWN IS INDICATIVE ONLY, AND REPRESENTS ASSUMED DELIVERY ROUTE(S) AND APPROXIMATE VEHICLE SIZE. SPECIFIC VEHICLE TO BE DETERMINED BY EQUIPMENT SUPPLIER / HAULIER.
6. DEFINITIVE VEHICLE TRACKING OF SPECIFIC DELIVERY VEHICLE TO BE CARRIED OUT BY HAULIER, TO ENSURE DESIRED MANOEUVRES ARE ACHIEVABLE, AND TO CONFIRM ANY REQUIRED ROAD WIDENING, TEMPORARY WORKS, etc.
7. ORDER LIMITS ARE TO THE OUTER EDGE OF THE RED LINE, WHICH IS AS PER PUBLISHED IN THE DCO DOCUMENTATION.
8. ON-SITE MEASUREMENTS RECORDED BY AECOM ON 05/08/2022.

THE ACCESS LOCATIONS ACROSS GRID CONNECTION ROUTES A AND B WILL BE RE-INSTATED TO THEIR CONDITION PRIOR TO THE CONSTRUCTION PHASE; HOWEVER, THE RIGHTS TO UTILISE THESE ACCESS POINTS WILL BE RETAINED DURING OPERATION AND SECURED THROUGH THE DCO TO ALLOW ACCESS FOR MAINTENANCE, IF REQUIRED. ACCESS TO THE GRID CONNECTION ROUTES A AND B IS NOT REQUIRED DURING DECOMMISSIONING AS THE CABLE AND INFRASTRUCTURE WILL REMAIN IN-SITU.

I/R	DATE	DESCRIPTION
D	2023-03-03	DEADLINE 7
C	2022-12-02	MINOR UPDATE DEADLINE 3B
B	2022-11-11	SECOND ISSUE
A	2022-09-23	FIRST ISSUE





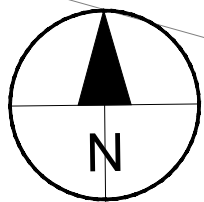
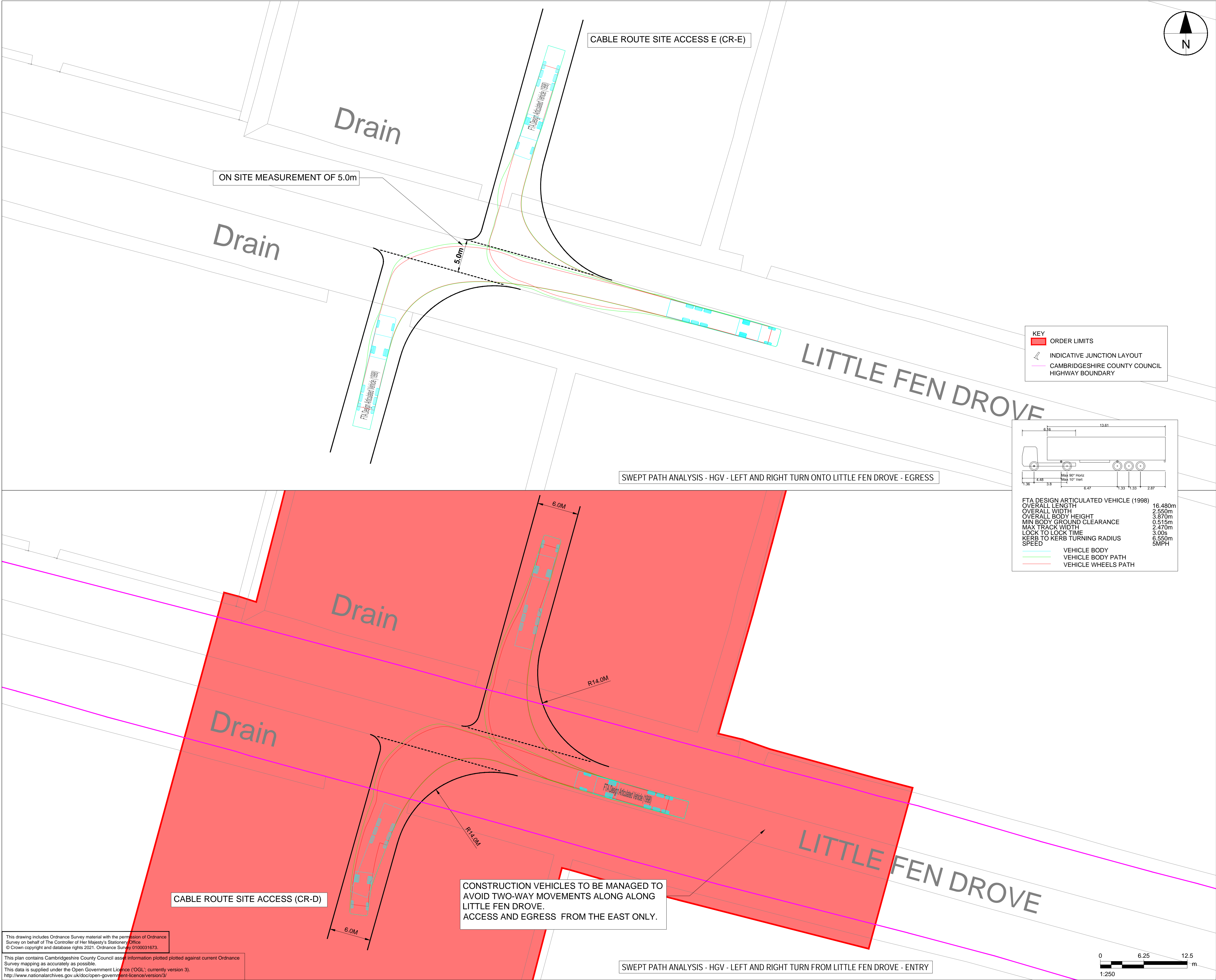

AECOM  
AECOM House, 63-77 Victoria Street,  
St. Albans, Hertfordshire, AL1 3ER  
+44(0)1727 535000 tel  
+44(0)1727 535099 fax  
www.aecom.com

- ALL DIMENSIONS ARE IN METRES UNLESS NOTED OTHERWISE
- ALL JUNCTION LAYOUTS AREA INDICATIVE
- THIS DRAWING IS BASED ON ORDNANCE SURVEY MASTERMAP MAPPING, AND AS SUCH, ALL INFORMATION SHOWN IS APPROXIMATE ONLY.
- ALL ROAD WIDTHS SHOWN, AS WELL AS POSITIONS OF EXISTING STREET FURNITURE, ARE APPROXIMATE ONLY.
- VEHICLE TRACKING SHOWN IS INDICATIVE ONLY, AND REPRESENTS ASSUMED DELIVERY ROUTE(S) AND APPROXIMATE VEHICLE SIZE. SPECIFIC VEHICLE TO BE DETERMINED BY EQUIPMENT SUPPLIER / HAULIER.
- DEFINITIVE VEHICLE TRACKING OF SPECIFIC DELIVERY VEHICLE TO BE CARRIED OUT BY HAULIER, TO ENSURE DESIRED MANOEUVRES ARE ACHIEVABLE, AND TO CONFIRM ANY REQUIRED ROAD WIDENING, TEMPORARY WORKS, etc.
- ORDER LIMITS ARE TO THE OUTER EDGE OF THE RED LINE, WHICH IS AS PER PUBLISHED IN THE DCO DOCUMENTATION.
- ON-SITE MEASUREMENTS RECORDED BY AECOM ON 05/08/2022.

SUMMARY OF USE

THE ACCESS LOCATIONS ACROSS GRID CONNECTION ROUTES A AND B WILL BE RE-INSTATED TO THEIR CONDITION PRIOR TO THE CONSTRUCTION PHASE; HOWEVER, THE RIGHTS TO UTILISE THESE ACCESS POINTS WILL BE RETAINED DURING OPERATION AND SECURED THROUGH THE DCO TO ALLOW ACCESS FOR MAINTENANCE, IF REQUIRED. ACCESS TO THE GRID CONNECTION ROUTES A AND B IS NOT REQUIRED DURING DECOMMISSIONING AS THE CABLE AND INFRASTRUCTURE WILL REMAIN IN-SITU.

ISSUE/REVISION

D	2023-03-03	DEADLINE 7
C	2022-12-02	MINOR UPDATE DEADLINE 3B
B	2022-11-11	SECOND ISSUE
A	2022-09-23	FIRST ISSUE
I/R	DATE	DESCRIPTION

KEY PLAN



PROJECT NUMBER

60589004

SHEET TITLE

CABLE ROUTE (CR-D & CR-E)  
SITE ACCESS D & E  
LITTLE FEN DROVE

SHEET NUMBER

ACM-60589004-AMR-DR-0030



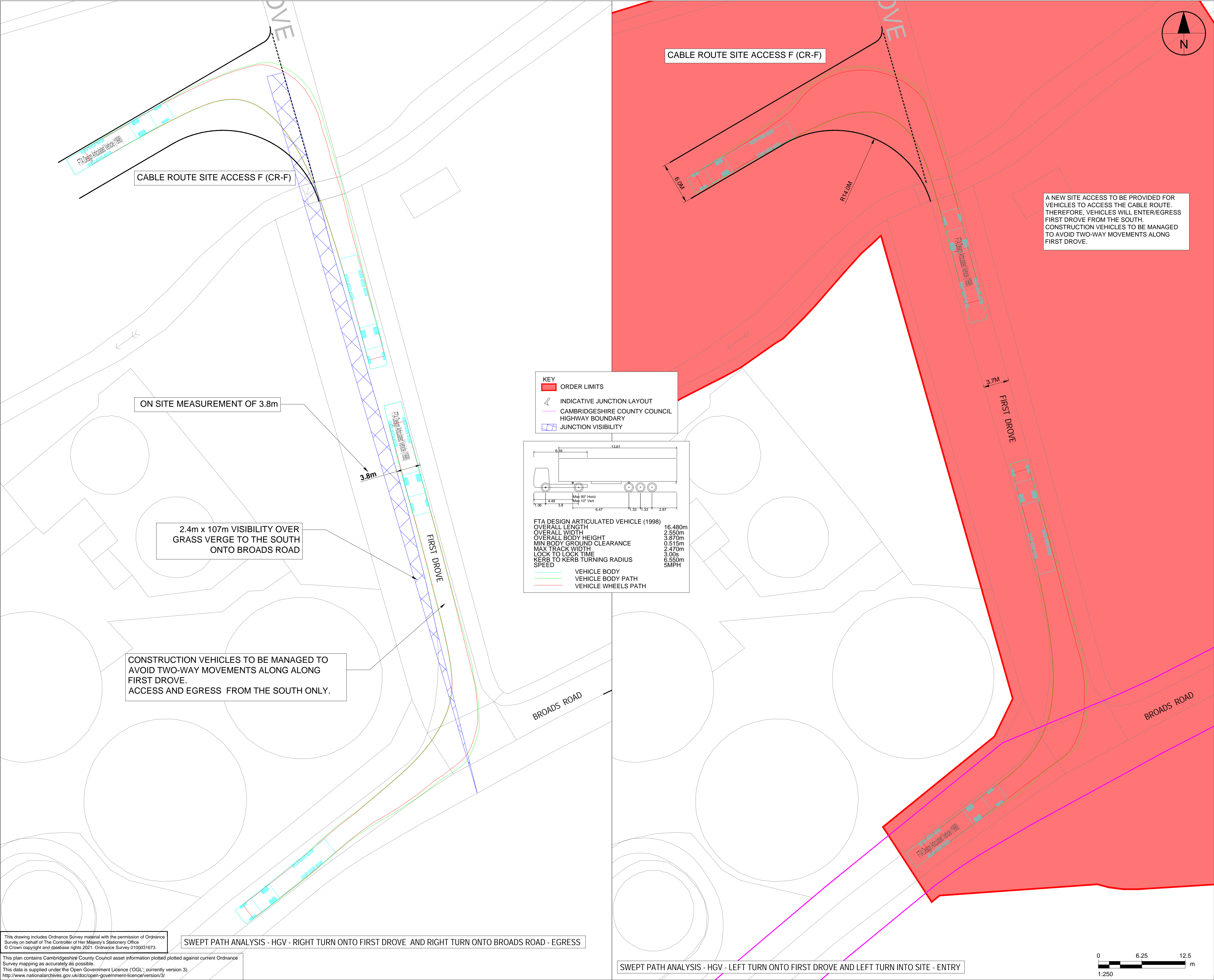

- ALL DIMENSIONS ARE IN METRES UNLESS NOTED OTHERWISE
- ALL JUNCTION LAYOUTS AREA INDICATIVE
- THIS DRAWING IS BASED ON ORDNANCE SURVEY MASTERMAP MAPPING, AND AS SUCH, ALL INFORMATION SHOWN IS APPROXIMATE ONLY.
- ALL ROAD WIDTHS SHOWN, AS WELL AS POSITIONS OF EXISTING STREET FURNITURE, ARE APPROXIMATE ONLY.
- VEHICLE TRACKING SHOWN IS INDICATIVE ONLY, AND REPRESENTS ASSUMED DELIVERY ROUTE(S) AND APPROXIMATE VEHICLE SIZE. SPECIFIC VEHICLE TO BE DETERMINED BY EQUIPMENT SUPPLIER / HAULIER.
- DEFINITIVE VEHICLE TRACKING OF SPECIFIC DELIVERY VEHICLE TO BE CARRIED OUT BY HAULIER, TO ENSURE DESIRED MANOEUVRES ARE ACHIEVABLE, AND TO CONFIRM ANY REQUIRED ROAD WIDENING, TEMPORARY WORKS, etc.
- ORDER LIMITS ARE TO THE OUTER EDGE OF THE RED LINE, WHICH IS AS PER PUBLISHED IN THE DCO DOCUMENTATION.
- ON-SITE MEASUREMENTS RECORDED BY AECOM ON 05/08/2022.

**SUMMARY OF USE**

THE ACCESS LOCATIONS ACROSS GRID CONNECTION ROUTES A AND B WILL BE RE-INSTATED TO THEIR CONDITION PRIOR TO THE CONSTRUCTION PHASE; HOWEVER, THE RIGHTS TO UTILISE THESE ACCESS POINTS WILL BE RETAINED DURING OPERATION AND SECURED THROUGH THE DCO TO ALLOW ACCESS FOR MAINTENANCE, IF REQUIRED. ACCESS TO THE GRID CONNECTION ROUTES A AND B IS NOT REQUIRED DURING DECOMMISSIONING AS THE CABLE AND INFRASTRUCTURE WILL REMAIN IN-SITU.

**ISSUE/REVISION**

D	2023-03-03	DEADLINE 7
C	2022-12-02	MINOR UPDATE DEADLINE 3B
B	2022-11-11	SECOND ISSUE
A	2022-09-23	FIRST ISSUE
I/R	DATE	DESCRIPTION

**KEY PLAN**



**PROJECT NUMBER**

60589004

**SHEET TITLE**

CABLE ROUTE (CR-F)  
SITE ACCESS F  
FIRST DROVE

**SHEET NUMBER**

ACM-60589004-AMR-DR-0031



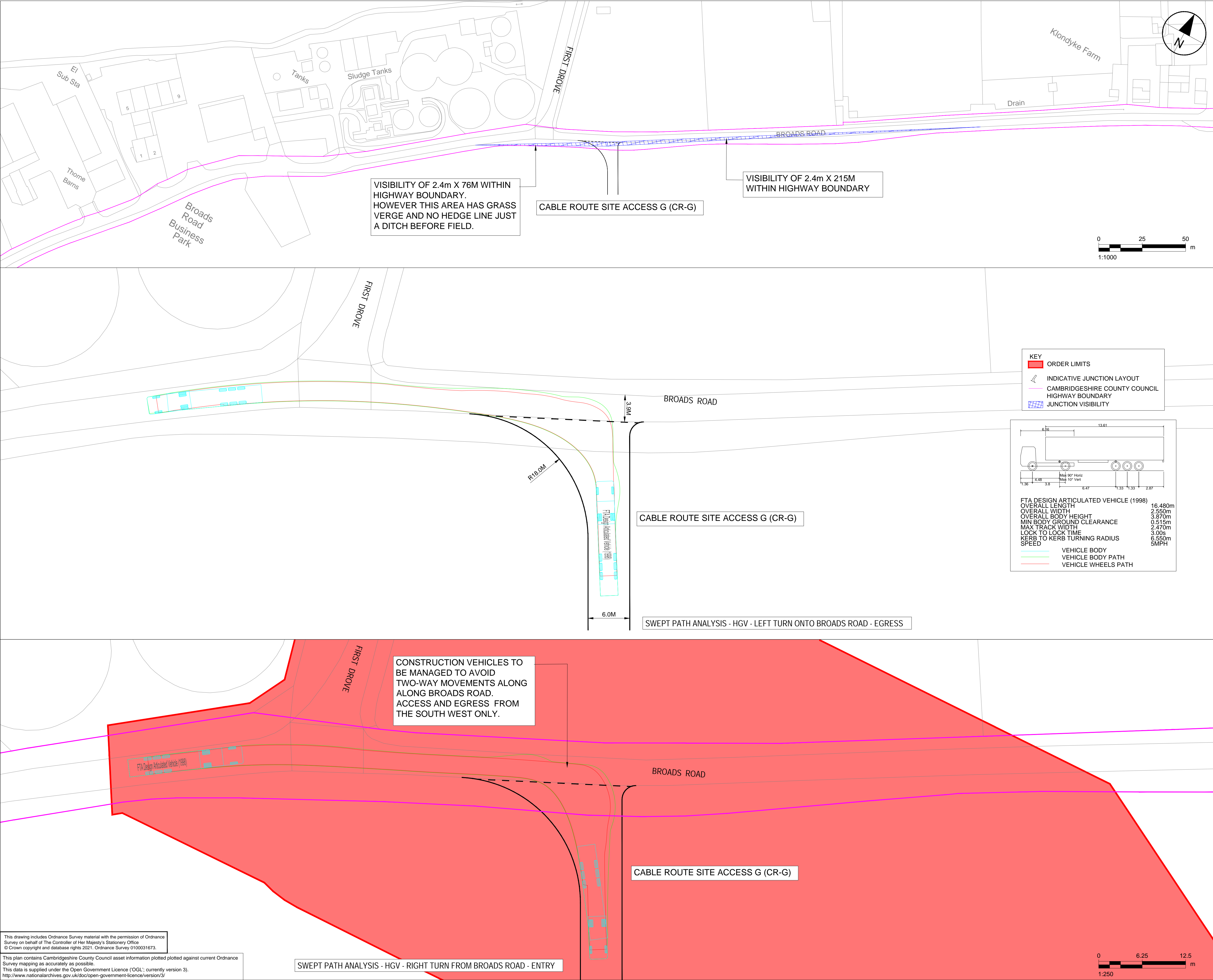

AECOM  
AECOM House, 63-77 Victoria Street,  
St. Albans, Hertfordshire, AL1 3ER  
+44(0)1727 535000 tel  
+44(0)1727 535099 fax  
www.aecom.com

1. ALL DIMENSIONS ARE IN METRES UNLESS NOTED OTHERWISE
2. ALL JUNCTION LAYOUTS AREA INDICATIVE
3. THIS DRAWING IS BASED ON ORDINANCE SURVEY MASTERMAP MAPPING, AND AS SUCH, ALL INFORMATION SHOWN IS APPROXIMATE ONLY.
4. ALL ROAD WIDTHS SHOWN, AS WELL AS POSITIONS OF EXISTING STREET FURNITURE, ARE APPROXIMATE ONLY.
5. VEHICLE TRACKING SHOWN IS INDICATIVE ONLY, AND REPRESENTS ASSUMED DELIVERY ROUTE(S) AND APPROXIMATE VEHICLE SIZE. SPECIFIC VEHICLE TO BE DETERMINED BY EQUIPMENT SUPPLIER / HAULIER.
6. DEFINITIVE VEHICLE TRACKING OF SPECIFIC DELIVERY VEHICLE TO BE CARRIED OUT BY HAULIER, TO ENSURE DESIRED MANOEUVRES ARE ACHIEVABLE, AND TO CONFIRM ANY REQUIRED ROAD WIDENING, TEMPORARY WORKS, etc.
7. ORDER LIMITS ARE TO THE OUTER EDGE OF THE RED LINE, WHICH IS AS PER PUBLISHED IN THE DCO DOCUMENTATION.

THE ACCESS LOCATIONS ACROSS GRID CONNECTION ROUTES A AND B WILL BE RE-INSTATED TO THEIR CONDITION PRIOR TO THE CONSTRUCTION PHASE; HOWEVER, THE RIGHTS TO UTILISE THESE ACCESS POINTS WILL BE RETAINED DURING OPERATION AND SECURED THROUGH THE DCO TO ALLOW ACCESS FOR MAINTENANCE, IF REQUIRED. ACCESS TO THE GRID CONNECTION ROUTES A AND B IS NOT REQUIRED DURING DECOMMISSIONING AS THE CABLE AND INFRASTRUCTURE WILL REMAIN IN-SITU.

I/R	DATE	DESCRIPTION
D	2023-03-03	DEADLINE 7
C	2022-12-02	MINOR UPDATE DEADLINE 3B
B	2022-11-11	SECOND ISSUE
A	2022-09-23	FIRST ISSUE



This drawing includes Ordnance Survey material with the permission of Ordnance Survey on behalf of The Controller of Her Majesty's Stationery Office  
© Crown copyright and database rights 2021. Ordnance Survey 0100031673.

This plan contains Cambridgeshire County Council asset information plotted plotted against current Ordnance Survey mapping as accurately as possible.  
This data is supplied under the Open Government Licence ('OGL'; currently version 3).  
<http://www.nationalarchives.gov.uk/doc/open-government-licence/version/3/>



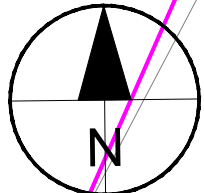
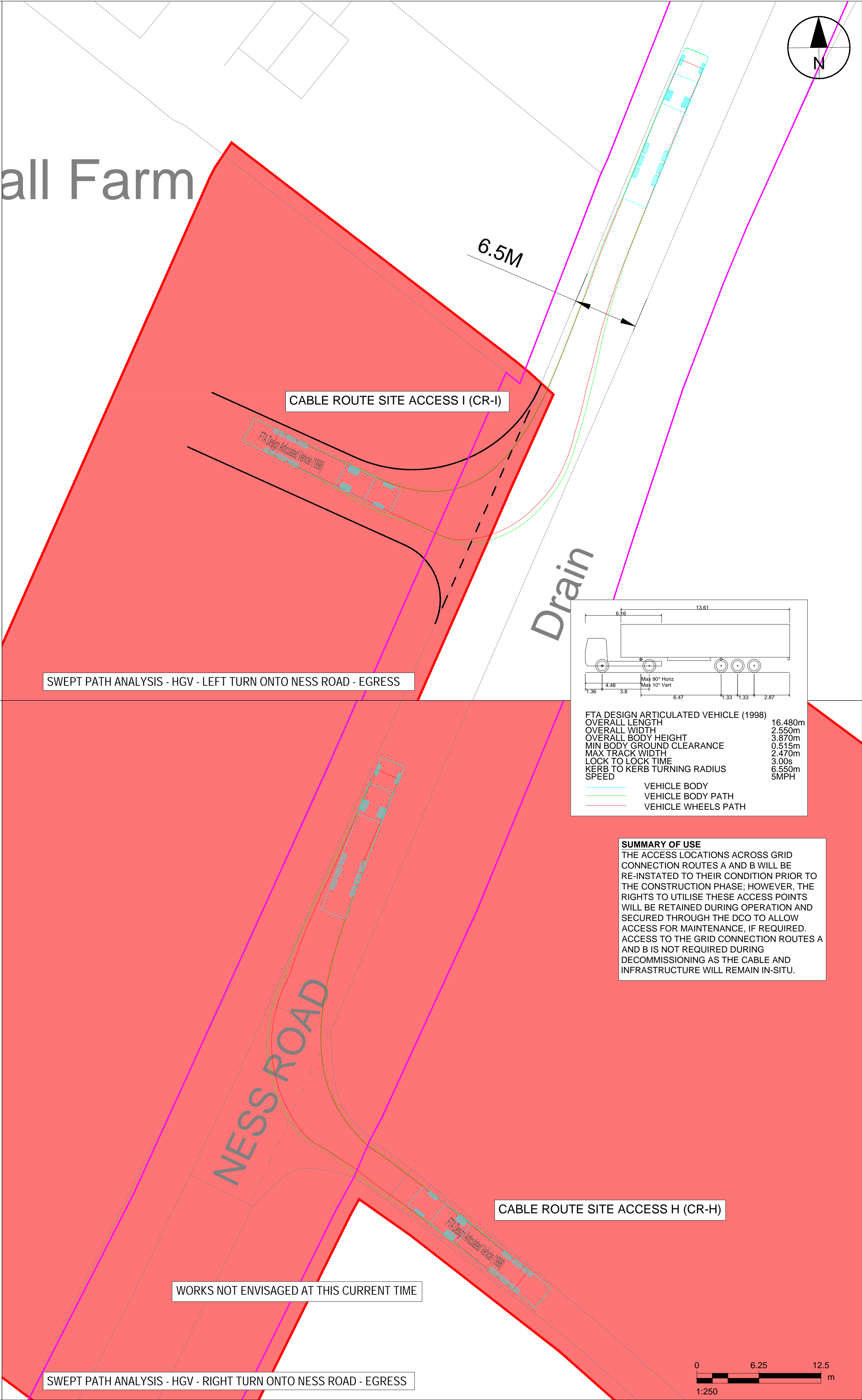
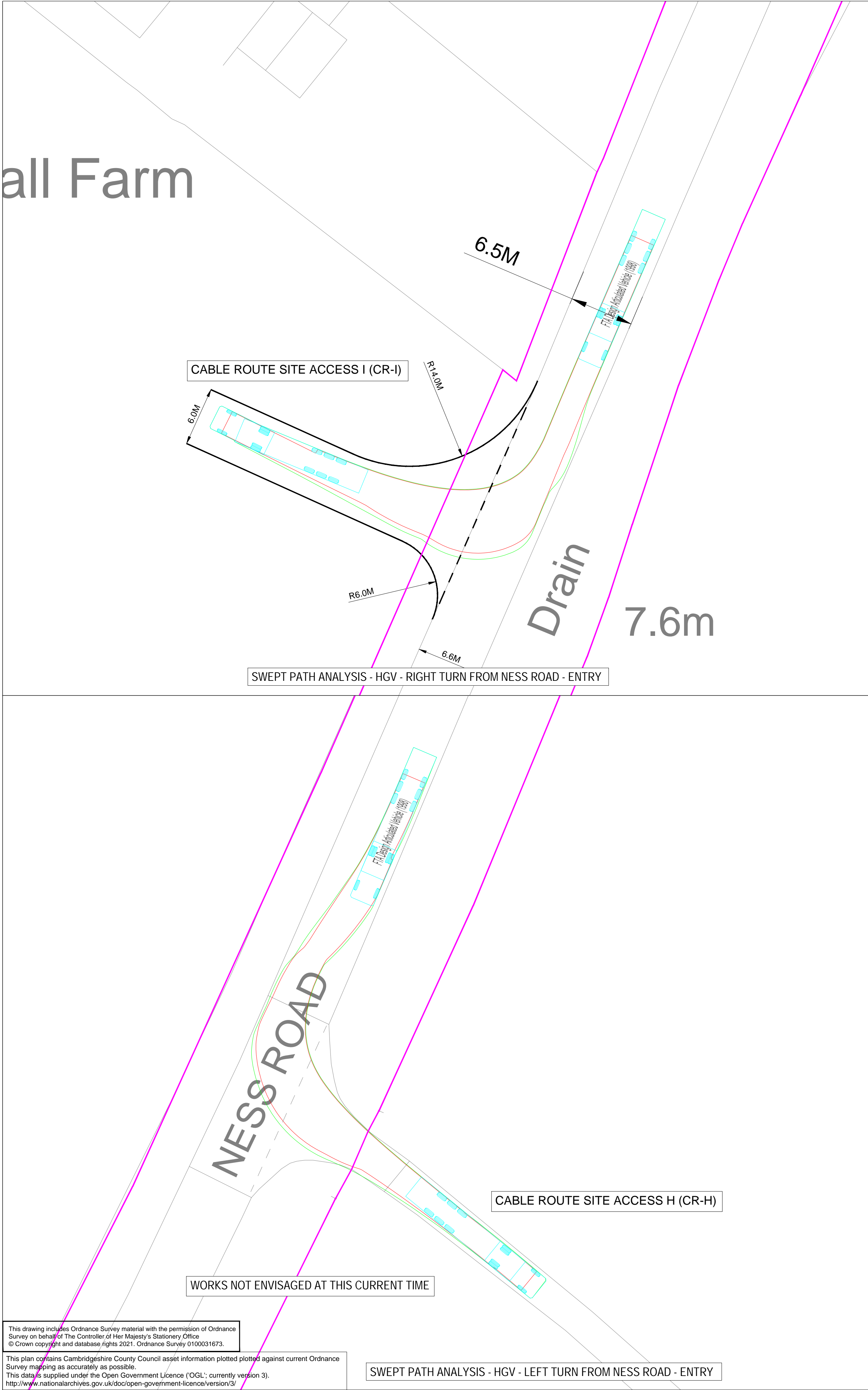

PROJECT



CLIENT

SUNNICA Ltd

CONSULTANT

AECOM  
AECOM House, 63-77 Victoria Street,  
St. Albans, Hertfordshire, AL1 3ER  
+44(0)1727 535000 tel  
+44(0)1727 535099 fax  
www.aecom.com

NOTE

1. ALL DIMENSIONS ARE IN METRES UNLESS NOTED OTHERWISE
2. ALL JUNCTION LAYOUTS AREA INDICATIVE
3. THIS DRAWING IS BASED ON ORDNANCE SURVEY MASTERMAP MAPPING, AND AS SUCH, ALL INFORMATION SHOWN IS APPROXIMATE ONLY.
4. ALL ROAD WIDTHS SHOWN, AS WELL AS POSITIONS OF EXISTING STREET FURNITURE, ARE APPROXIMATE ONLY.
5. VEHICLE TRACKING SHOWN IS INDICATIVE ONLY, AND REPRESENTS ASSUMED DELIVERY ROUTE(S) AND APPROXIMATE VEHICLE SIZE. SPECIFIC VEHICLE TO BE DETERMINED BY EQUIPMENT SUPPLIER / HAULIER.
6. DEFINITIVE VEHICLE TRACKING OF SPECIFIC DELIVERY VEHICLE TO BE CARRIED OUT BY HAULIER, TO ENSURE DESIRED MANOEUVRES ARE ACHIEVABLE, AND TO CONFIRM ANY REQUIRED ROAD WIDENING, TEMPORARY WORKS, etc.
7. ORDER LIMITS ARE TO THE OUTER EDGE OF THE RED LINE, WHICH IS AS PER PUBLISHED IN THE DCO DOCUMENTATION.

KEY

- ORDER LIMITS
- INDICATIVE JUNCTION LAYOUT
- CAMBRIDGESHIRE COUNTY COUNCIL HIGHWAY BOUNDARY

**TRAFFIC REGULATION MEASURES**  
TO PROVIDE SAFE ENTRY AND EGRESS OF THE NORTHERN SITE ACCESS. TEMPORARY TRAFFIC SIGNALS ARE PROPOSED WHILST THE SITE ACCESS IS IN USE DURING THE CONSTRUCTION PERIOD. IN ADDITION A TEMPORARY SPEED LIMIT REDUCTION IS PROPOSED ALONG NESS ROAD. THESE ARE SHOWN ON SHEET NUMBER 60589004-TRM-TM-002 AND 60589004-TRM-TM-003 IN THE TRAFFIC REGULATION MEASURES PLAN TEMPORARY MEASURES.

ISSUE/REVISION

I/R	DATE	DESCRIPTION
D	2023-03-03	DEADLINE 7
C	2022-11-28	MINOR UPDATE DEADLINE 3A
B	2022-11-11	SECOND ISSUE
A	2022-09-23	FIRST ISSUE

KEY PLAN



PROJECT NUMBER

60589004

SHEET TITLE

CABLE ROUTE (CR-H) & (CR-I)  
SITE ACCESS H & I  
NESS ROAD (SHEET 1 OF 2)

SHEET NUMBER

ACM-60589004-AMR-DR-0033

This drawing includes Ordnance Survey material with the permission of Ordnance Survey on behalf of The Controller of Her Majesty's Stationery Office.  
© Crown copyright and database rights 2021. Ordnance Survey 0100031673.

This plan contains Cambridgeshire County Council asset information plotted against current Ordnance Survey mapping as accurately as possible.  
This data is supplied under the Open Government Licence (OGL; currently version 3).  
<http://www.nationalarchives.gov.uk/doc/open-government-licence/version/3/>

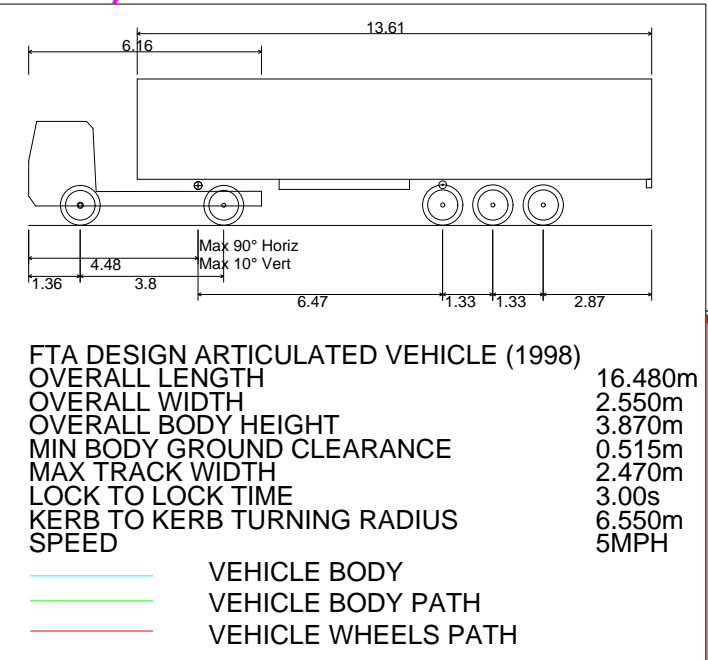

**SUMMARY OF USE**  
THE ACCESS LOCATIONS ACROSS GRID CONNECTION ROUTES A AND B WILL BE RE-INSTATED TO THEIR CONDITION PRIOR TO THE CONSTRUCTION PHASE; HOWEVER, THE RIGHTS TO UTILISE THESE ACCESS POINTS WILL BE RETAINED DURING OPERATION AND SECURED THROUGH THE DCO TO ALLOW ACCESS FOR MAINTENANCE, IF REQUIRED. ACCESS TO THE GRID CONNECTION ROUTES A AND B IS NOT REQUIRED DURING DECOMMISSIONING AS THE CABLE AND INFRASTRUCTURE WILL REMAIN IN-SITU.



This drawing includes Ordnance Survey material with the permission of Ordnance Survey on behalf of The Controller of Her Majesty's Stationery Office.  
© Crown copyright and database rights 2021. Ordnance Survey 0100031673.

This plan contains Cambridgeshire County Council asset information plotted plotted against current Ordnance Survey mapping as accurately as possible.  
This data is supplied under the Open Government Licence ('OGL'; currently version 3).  
<http://www.nationalarchives.gov.uk/doc/open-government-licence/version/3/>

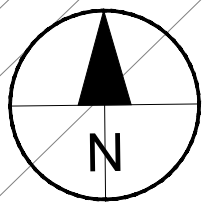

**SUMMARY OF USE**  
THE ACCESS LOCATIONS ACROSS GRID CONNECTION ROUTES A AND B WILL BE RE-INSTATED TO THEIR CONDITION PRIOR TO THE CONSTRUCTION PHASE; HOWEVER, THE RIGHTS TO UTILISE THESE ACCESS POINTS WILL BE RETAINED DURING OPERATION AND SECURED THROUGH THE DCO TO ALLOW ACCESS FOR MAINTENANCE, IF REQUIRED. ACCESS TO THE GRID CONNECTION ROUTES A AND B IS NOT REQUIRED DURING DECOMMISSIONING AS THE CABLE AND INFRASTRUCTURE WILL REMAIN IN-SITU.

- KEY**
- ORDER LIMITS
  - INDICATIVE JUNCTION LAYOUT
  - VEGETATION REMOVAL REQUIRED
  - TEMPORARY TRAFFIC SIGNALS
  - TEMPORARY SPEED REDUCTION
  - ACHIEVABLE SITE ACCESS VISIBILITY
  - CAMBRIDGESHIRE COUNTY COUNCIL HIGHWAY BOUNDARY



PROJECT



CLIENT

SUNNICA Ltd

CONSULTANT

AECOM  
AECOM House, 63-77 Victoria Street,  
St. Albans, Hertfordshire, AL1 3ER  
+44(0)1727 535000 tel  
+44(0)1727 535099 fax  
[www.aecom.com](http://www.aecom.com)

NOTE

- ALL DIMENSIONS ARE IN METRES UNLESS NOTED OTHERWISE
- ALL JUNCTION LAYOUTS AREA INDICATIVE
- THIS DRAWING IS BASED ON ORDNANCE SURVEY MASTERMAP MAPPING, AND AS SUCH, ALL INFORMATION SHOWN IS APPROXIMATE ONLY.
- ALL ROAD WIDTHS SHOWN, AS WELL AS POSITIONS OF EXISTING STREET FURNITURE, ARE APPROXIMATE ONLY.
- VEHICLE TRACKING SHOWN IS INDICATIVE ONLY, AND REPRESENTS ASSUMED DELIVERY ROUTE(S) AND APPROXIMATE VEHICLE SIZE. SPECIFIC VEHICLE TO BE DETERMINED BY EQUIPMENT SUPPLIER / HAULIER.
- DEFINITIVE VEHICLE TRACKING OF SPECIFIC DELIVERY VEHICLE TO BE CARRIED OUT BY HAULIER, TO ENSURE DESIRED MANOEUVRES ARE ACHIEVABLE, AND TO CONFIRM ANY REQUIRED ROAD WIDENING, TEMPORARY WORKS, etc.
- ORDER LIMITS ARE TO THE OUTER EDGE OF THE RED LINE, WHICH IS AS PER PUBLISHED IN THE DCO DOCUMENTATION.

**TRAFFIC REGULATION MEASURES**  
TO PROVIDE SAFE ENTRY AND EGRESS OF THE NORTHERN SITE ACCESS, TEMPORARY TRAFFIC SIGNALS ARE PROPOSED WHILST THE SITE ACCESS IS IN USE DURING THE CONSTRUCTION PERIOD. IN ADDITION A TEMPORARY SPEED LIMIT REDUCTION IS PROPOSED ALONG NESS ROAD. THESE ARE SHOWN ON SHEET NUMBER 60589004-TRM-TM-002 AND 60589004-TRM-TM-003 IN THE TRAFFIC REGULATION MEASURES PLAN TEMPORARY MEASURES.

ISSUE/REVISION

I/R	DATE	DESCRIPTION
C	2023-03-03	DEADLINE 7
B	2022-11-28	MINOR UPDATE DEADLINE 3A
A	2022-11-11	FIRST ISSUE

KEY PLAN



PROJECT NUMBER

60589004

SHEET TITLE

CABLE ROUTE (CR-H) & (CR-I)  
SITE ACCESS H & I, NESS ROAD  
TEMPORARY TRAFFIC SIGNALS  
AND VISIBILITY (SHEET 2 OF 2)  
**SHEET NUMBER**

ACM-60589004-AMR-DR-0034



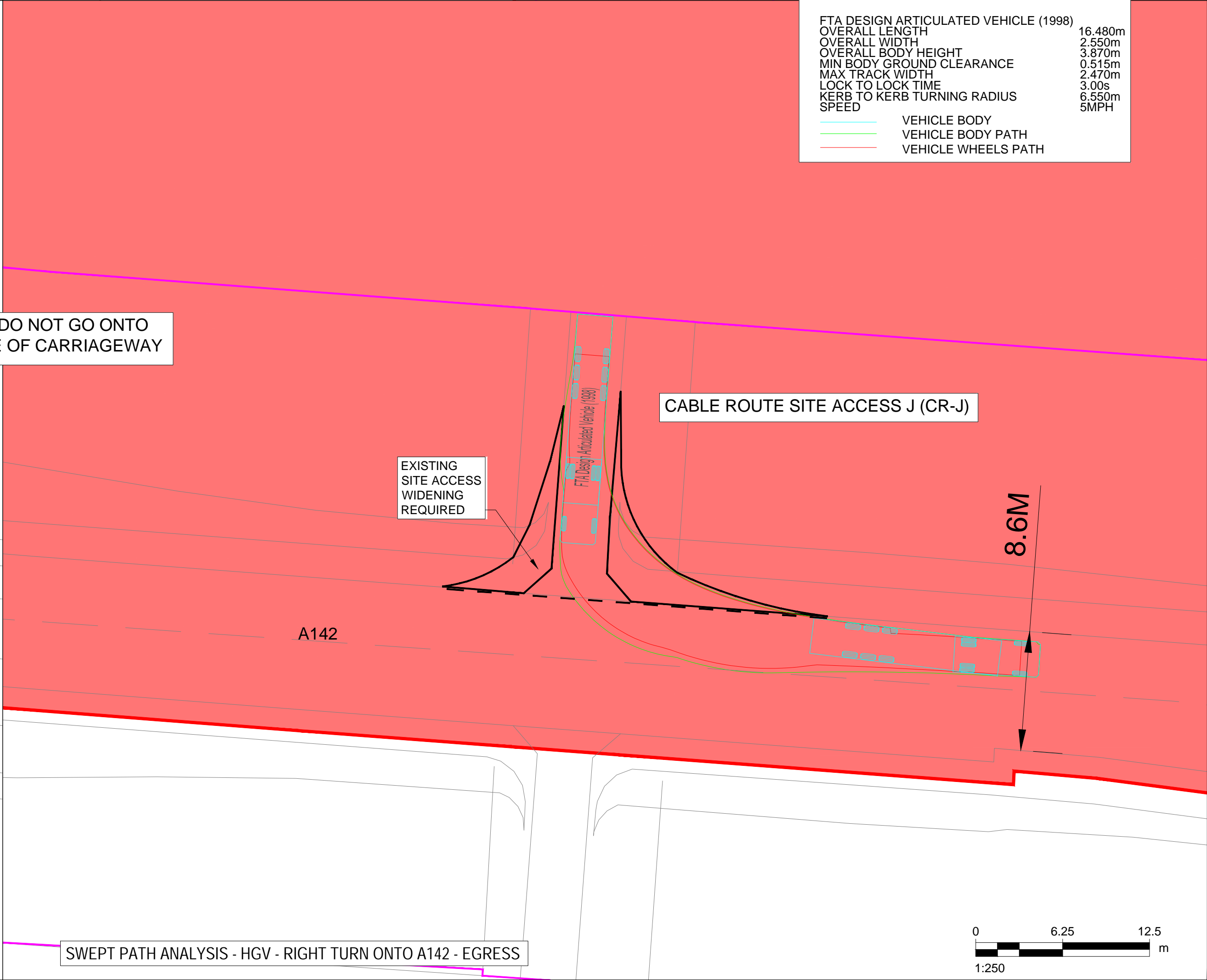
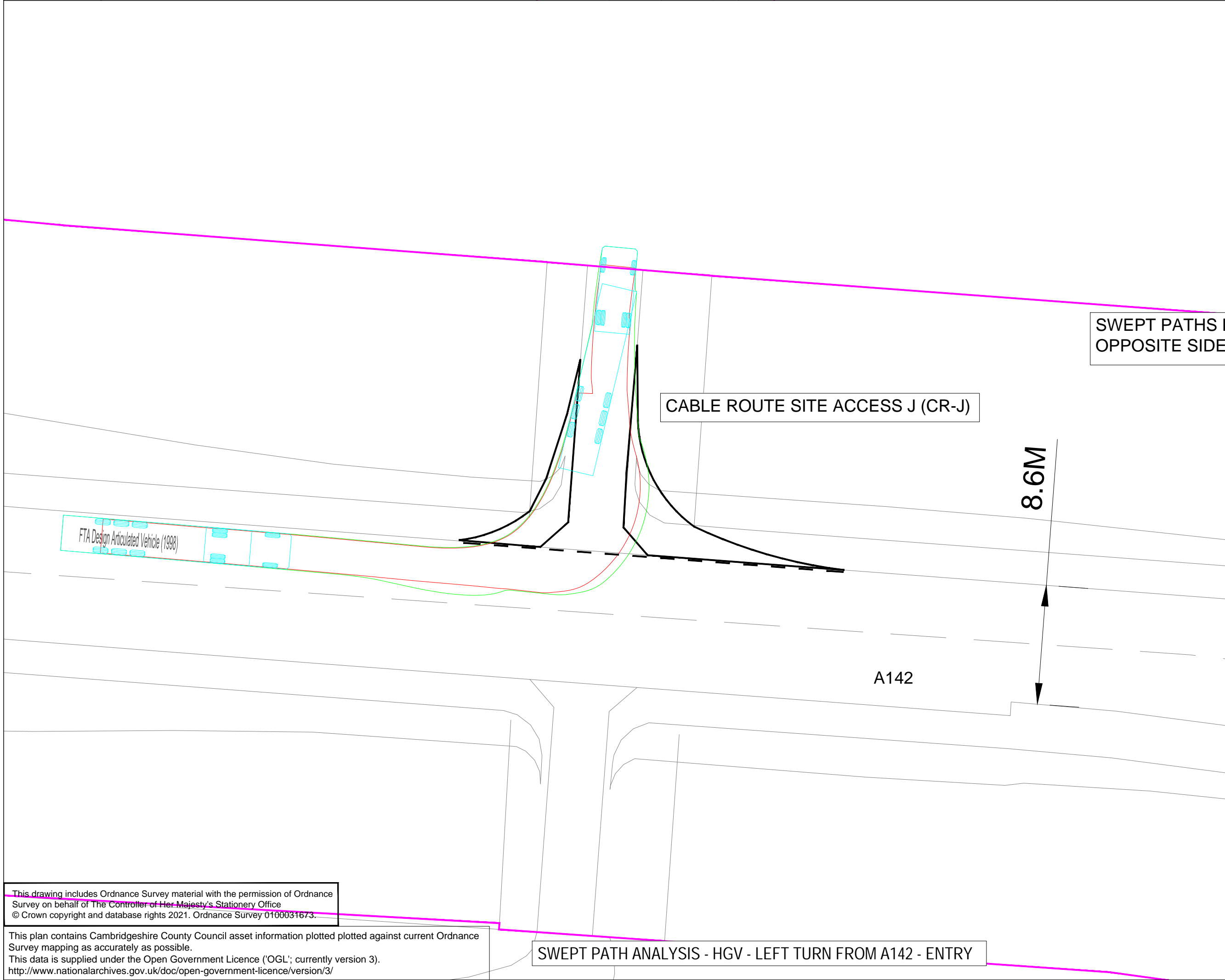
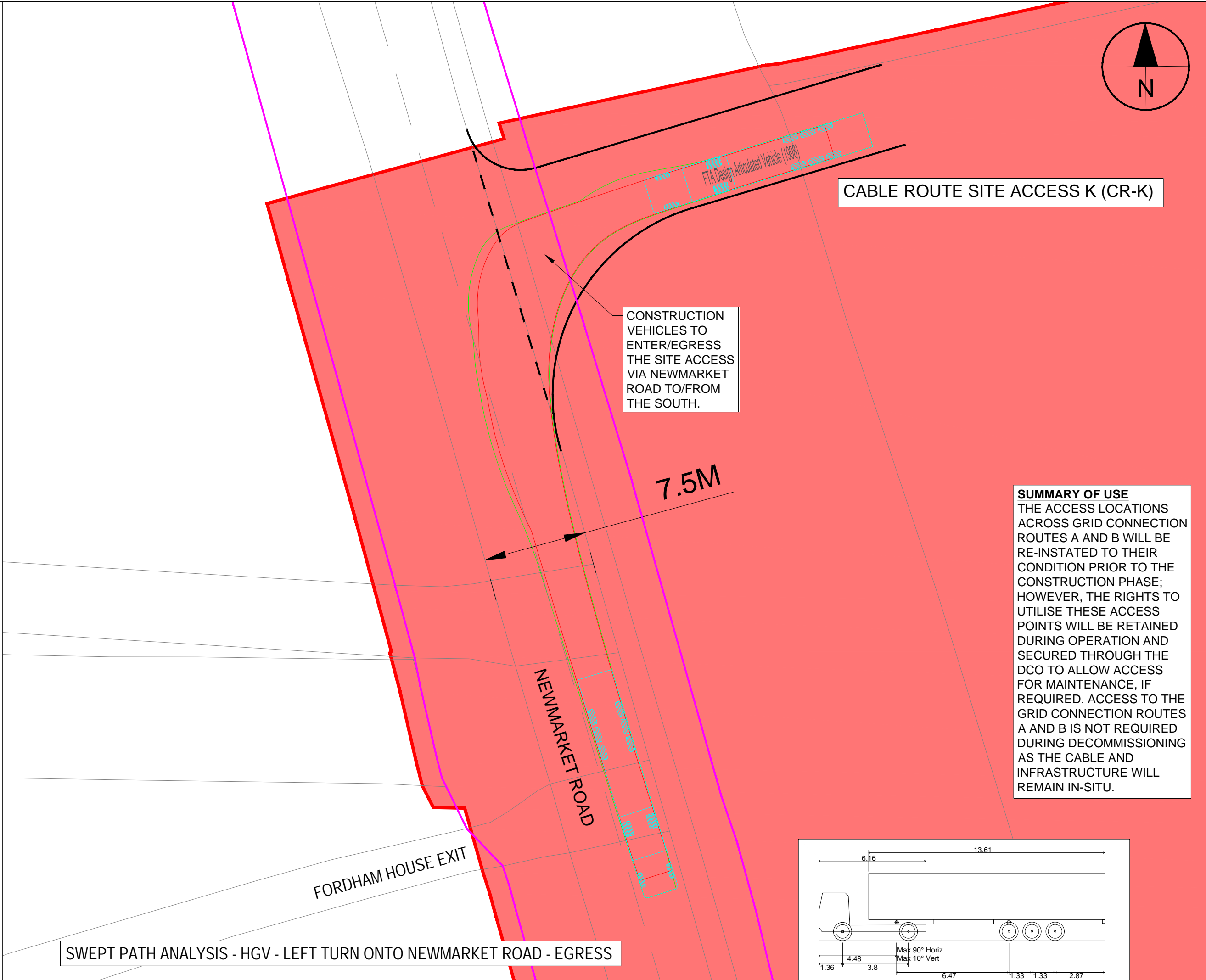
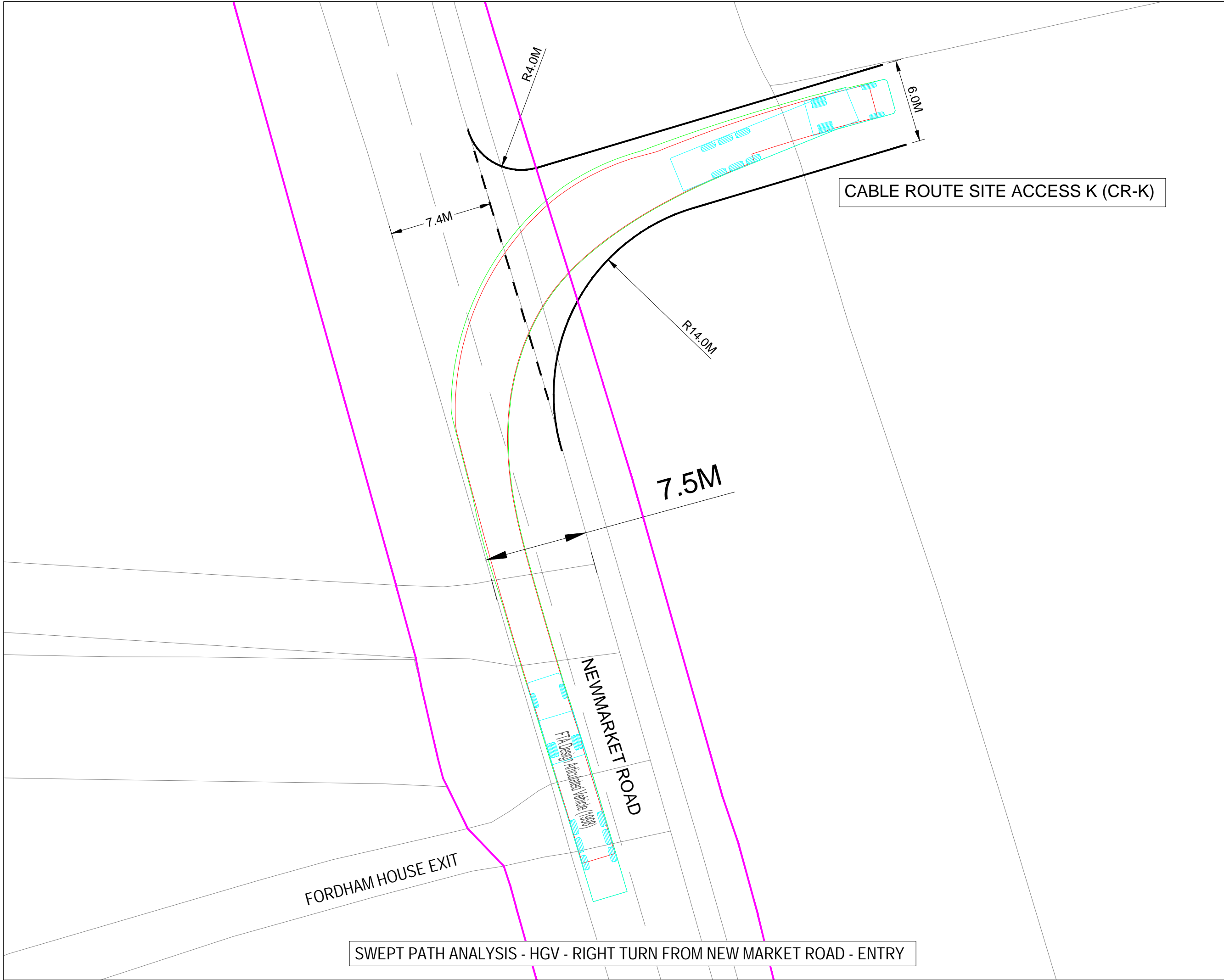

1. ALL DIMENSIONS ARE IN METRES UNLESS NOTED OTHERWISE
2. ALL JUNCTION LAYOUTS AREA INDICATIVE
3. THIS DRAWING IS BASED ON ORDNANCE SURVEY MASTERMAP MAPPING, AND AS SUCH, ALL INFORMATION SHOWN IS APPROXIMATE ONLY.
4. ALL ROAD WIDTHS SHOWN, AS WELL AS POSITIONS OF EXISTING STREET FURNITURE, ARE APPROXIMATE ONLY.
5. VEHICLE TRACKING SHOWN IS INDICATIVE ONLY, AND REPRESENTS ASSUMED DELIVERY ROUTE(S) AND APPROXIMATE VEHICLE SIZE. SPECIFIC VEHICLE TO BE DETERMINED BY EQUIPMENT SUPPLIER / HAULIER.
6. DEFINITIVE VEHICLE TRACKING OF SPECIFIC DELIVERY VEHICLE TO BE CARRIED OUT BY HAULIER, TO ENSURE DESIRED MANOEUVRES ARE ACHIEVABLE, AND TO CONFIRM ANY REQUIRED ROAD WIDENING, TEMPORARY WORKS, etc.
7. ORDER LIMITS ARE TO THE OUTER EDGE OF THE RED LINE, WHICH IS AS PER PUBLISHED IN THE DCO DOCUMENTATION.

ORDER LIMITS

INDICATIVE JUNCTION LAYOUT  
CAMBRIDGESHIRE COUNTY COUNCIL  
HIGHWAY BOUNDARY

TRAFFIC REGULATION MEASURES

TO PROVIDE SAFE ENTRY AND EGRESS OF THE NEWMARKET ROAD SITE ACCESS, TEMPORARY TRAFFIC SIGNALS AND TEMPORARY SPEED LIMIT REDUCTIONS ARE PROPOSED WHILST THE SITE ACCESS IS IN USE DURING THE CONSTRUCTION PERIOD. THESE ARE SHOWN ON SHEET NUMBER 60589004-TRM-TM-004 AND 60589004-TRM-TM-005 IN THE TRAFFIC REGULATION MEASURES PLAN TEMPORARY MEASURES.

ISSUE/REVISION

I/R	DATE	DESCRIPTION
D	2023-03-03	DEADLINE 7
C	2022-11-28	MINOR UPDATE DEADLINE 3A
B	2022-11-11	SECOND ISSUE
A	2022-09-23	FIRST ISSUE

KEY PLAN



PROJECT NUMBER

60589004

SHEET TITLE

CABLE ROUTE (CR-J) & (CR-K)  
SITE ACCESS J & K  
A142 / NEWMARKET ROAD  
(SHEET 1 OF 2)  
SHEET NUMBER

ACM-60589004-AMR-DR-0035